

# Conquik

## Slab-In-A-Box

ASSEMBLY INSTRUCTIONS

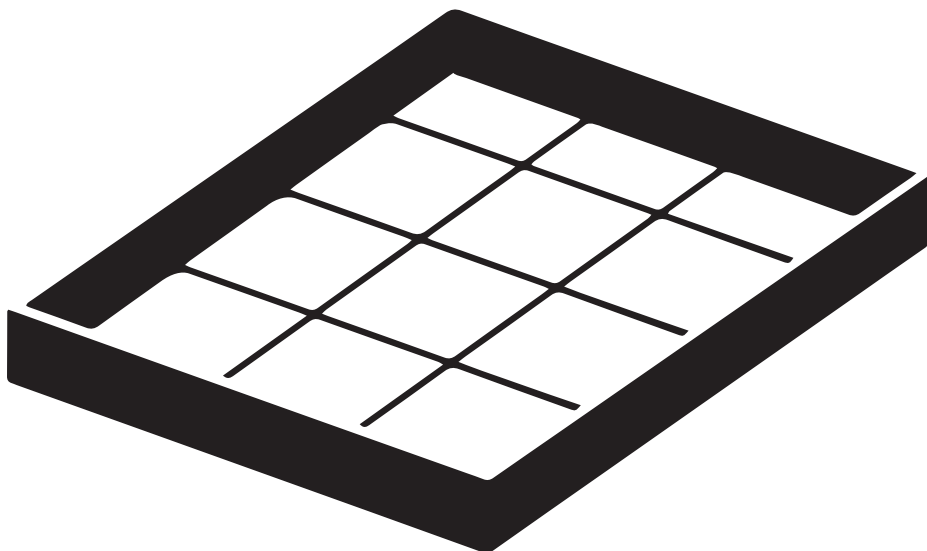

AUSTRALIAN  
MADE



PATENTED  
TECHNOLOGY



REINFORCED  
SLAB



QUALITY  
ASSURED



FAST & EASY  
ASSEMBLY



[sales@conquik.com.au](mailto:sales@conquik.com.au)



[www.conquik.com.au](http://www.conquik.com.au)

# #TAGYOURSLAB

## TAG YOUR SLAB AT

[www.conquik.com.au](http://www.conquik.com.au)

Congratulations on your new **Conquik Slab-in-a-Box** purchase! We hope you have fun assembling it.

If you need more information on how to assemble your **Conquik Slab-in-a-Box panel** please see our YouTube Instruction video. **Just search for "Conquik Slab in a Box" on YouTube.**



**Or scan this QR Code to see online videos and instruction guide.**

At **Conquik®** we are committed to providing our customers with new and innovative DIY concrete solutions. We would love to hear how your slab pour went and any feedback you may have.

We'd also love to see your Conquik project! If you're happy to showcase your slab on our website, please upload photos of your completed slab and leave a comment at [www.conquik.com.au/tagyourslab](http://www.conquik.com.au/tagyourslab)

You can also follow us on Facebook & Instagram

**#TAGYOURSLAB**

# SAFETY WARNINGS & NOTICES

**DISCLAIMER:** Note the following instruction manual is not to scale. Associated videos are for instructional purposes and should be used as a guide only. It is recommended that you undertake a risk assessment, and follow the instructions on the back of the concrete pack to identify a safe work method before starting the assembly process.

Failure to follow the warnings below may result in serious injury, and/or property damage, and will void warranty

- To ensure safety, make sure that you wear gloves, safety glasses and protective footwear and clothing when working with concrete, and read the safety guidelines on the back of the concrete or cement bags.
- Make sure that the ground has been completely levelled before placing the panel and pouring the concrete.
- To be completed by an adult or under the supervision of an adult.
- Do not install or store near hot objects such as outside fireplaces.
- Do not stand or bounce on the reinforcement mesh once the panel is assembled.
- Follow the installation guidelines and add the concrete slurry carefully with a shovel, or using a concrete pump after securing the panels.
- The plastic components can be damaged by excessive force. To avoid damage, handle with care. For example, do not push your wheelbarrow over the side-form.
- This panel has been designed to meet the building codes when assembled and installed properly
- Conquik does not take any responsibility or liability for the quality of concrete installed, which can lead to cracking.

# MATERIALS

## A | PANEL ASSEMBLY

### Box Components

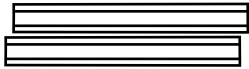

long side-forms (2x)



short side-forms (2x)



side clips

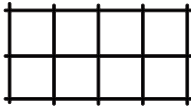

reinforcement mesh (1x)

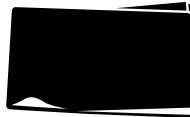

plastic builders film (1x)

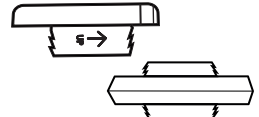

corner clips (4x)

## B | POURING YOUR SLAB

### Tools & components required (not included)

- Gloves
- Protective footwear
- Safety glasses
- Tape measure
- Bags of premixed concrete
- Screed
- Stanley knife
- Trowel
- Wooden float/finishing trowel/  
stiff finishing broom
- Level
- Bucket

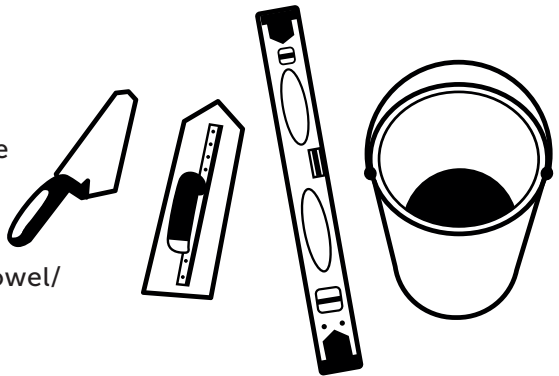

# C | ASSEMBLING PANEL

## STEP 1 - Insert clips onto reinforcement mesh

Place clips at an angle (don't twist on to the reinforcing yet). Note that you will have to orientate the clip to match the reinforcement bar that it will clip onto (top or bottom).

Make sure to place the corner clips like the configuration in the image.

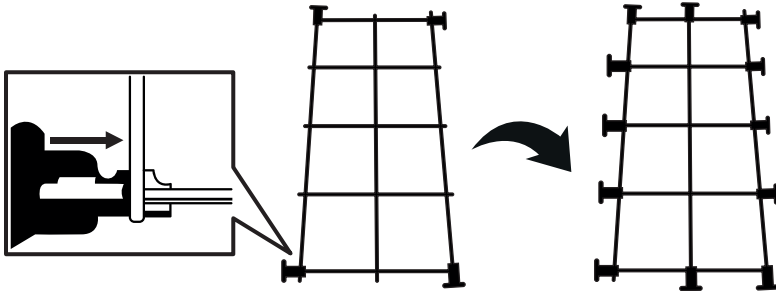

**FOR A SINGLE PANEL INSTALL, GO TO STEP 3.  
DO STEP 2 IF YOU ARE JOINING TOGETHER 2+ PANELS.**

## STEP 2 - Tear off top section of side-form

Before assembling each panel, identify the two side-forms of the panels which are to be joined together. Make sure they are the same length.

Starting in one corner, use both hands to push the top curved portion from the inside-out, like you're folding it over. This will expose an indented white line. Keep pushing the top section until it separates from the main body of the side-form. Continue peeling this strip section off the rest of the side-form, working your way down the length of the side-form until the strip is completely removed.

Repeat on the other side-form length.

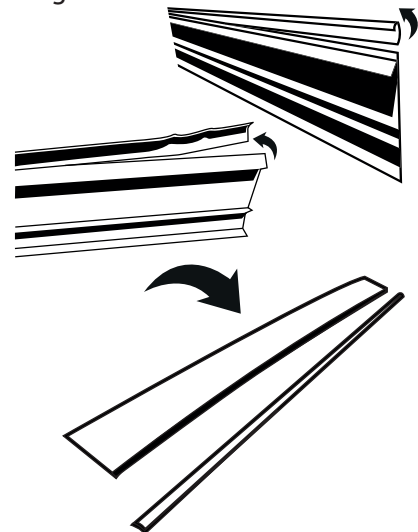

# STEP 3 - Insert the side clips into the groove of the longer side-forms & twist-lock

Line up the side-form lengths along the matching sides of the mesh. Place the side-form with the rounded top edge facing up, and the straight edge on the ground.

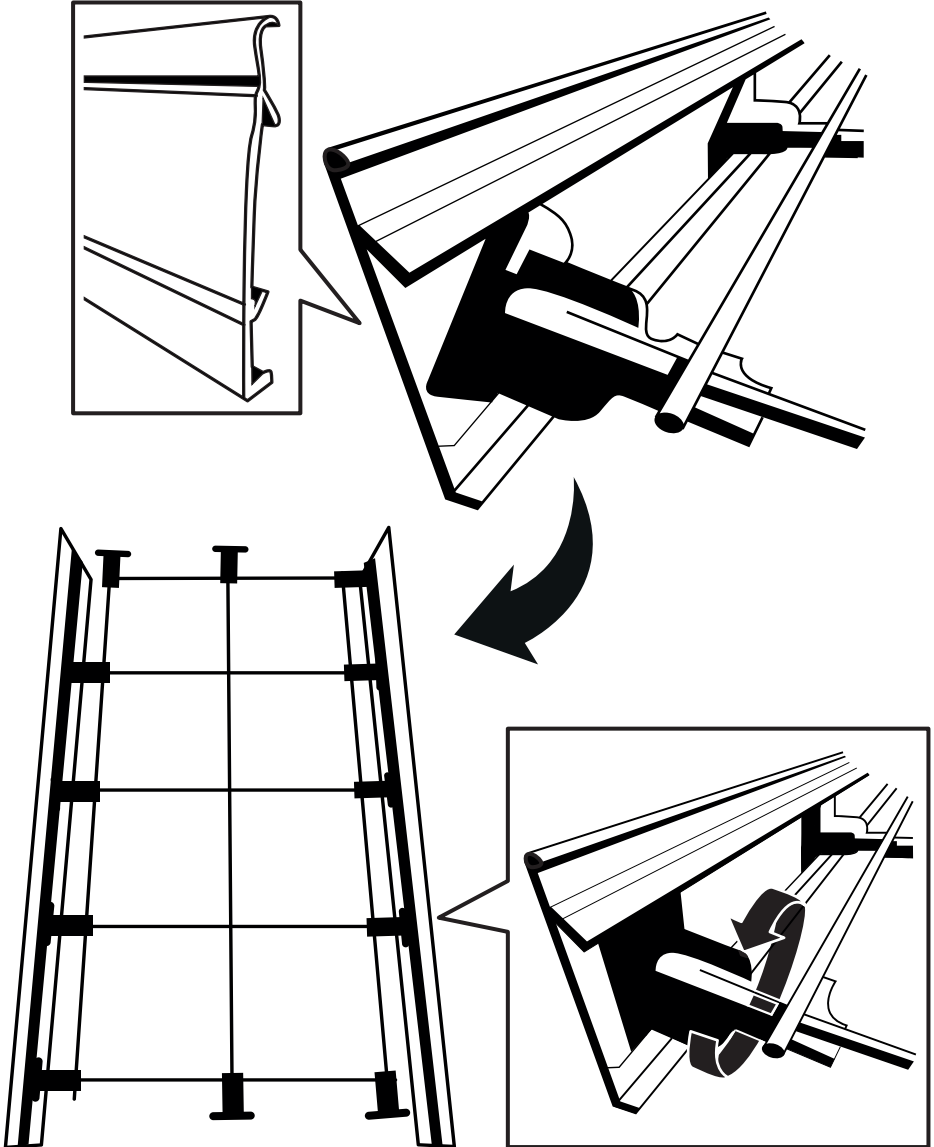

## STEP 4 - Insert one corner clip into each side-form

With the round edge of the corner clip matching the top round edge of the side-form, push one corner clip tightly into each side-form.

Pay close attention to the images and the orientation of the side clips and the corner pieces (shown in the circles).

The configuration is further outlined in below images:

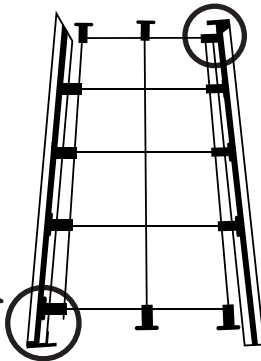
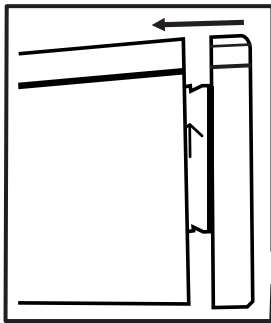
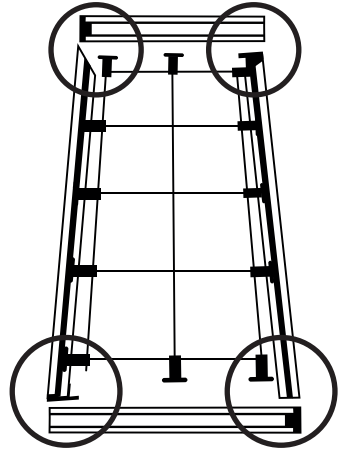

**Note:** Tap the side-form into position so the adjacent side-forms can line up with each other. The side-form will be able to slide when side clips are twist-locked into position.

Insert & twist-lock the remaining side clips, leaving an overhang as shown.

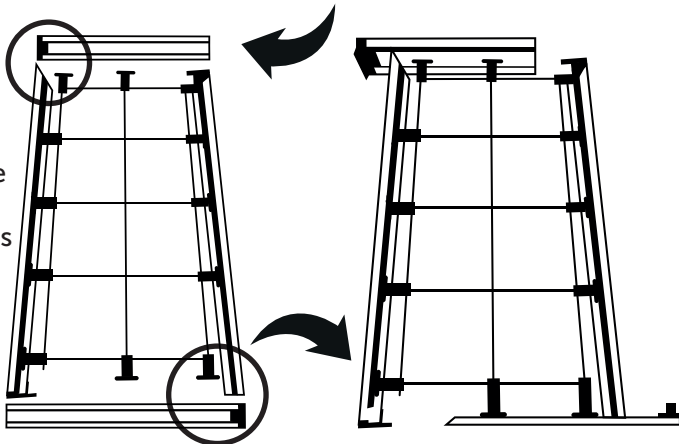

# STEP 5 - Slide & push corner clips into side-form & push corners tight

**Note:** The side-form is flexible, so it can be bent slightly if necessary to engage the corner clips.

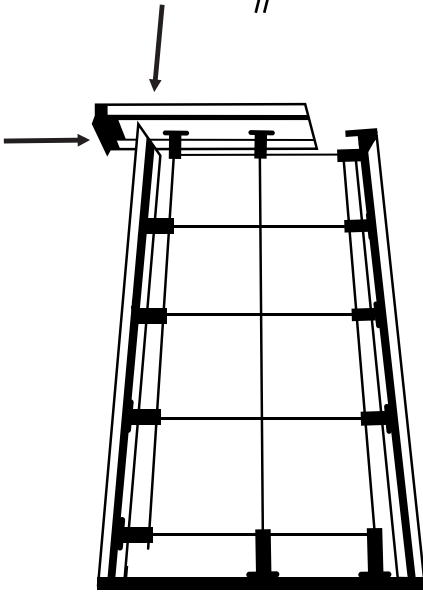
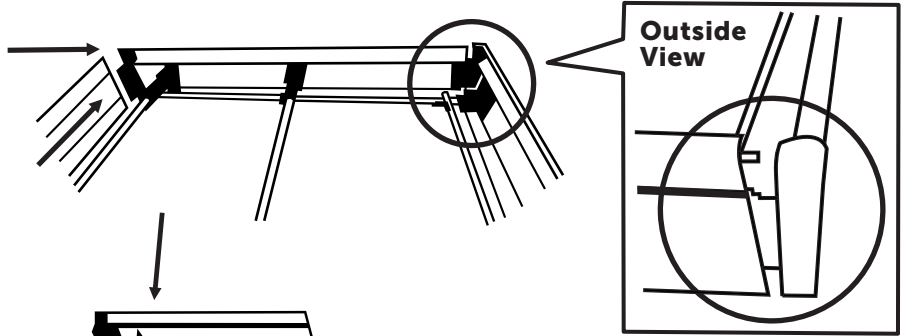

Tap corners into position if required & ensure that all side clips are sitting in the groove and twist-locked onto the reinforcing mesh.

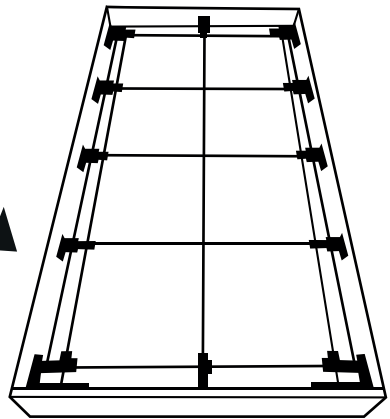
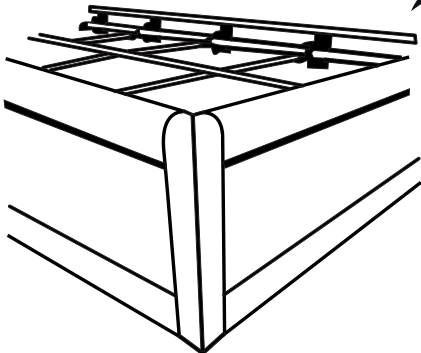

**YOUR CONQUIK  
SLAB-IN-A-BOX PANEL  
IS NOW ASSEMBLED AND  
READY TO PLACE AND POUR  
THE CONCRETE!**



# D | POURING YOUR SLAB

***Note the following is a guide only. Make sure to check the instruction details on your concrete or cement mix bags, & follow any local regulations that may apply.***

## STEP 6 - Identify and clear the site

Make sure that you clear all organic matter from the area.

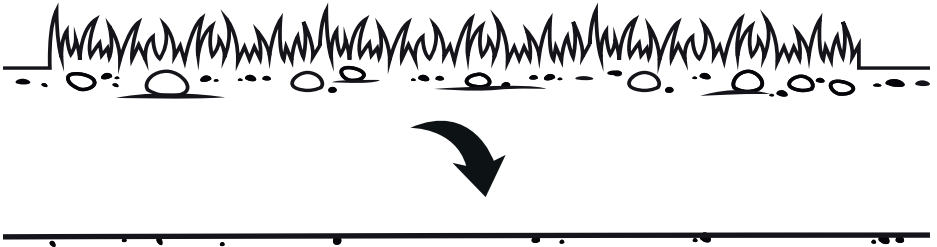

## STEP 7 - Level the ground to eliminate high or low spots

Level the site by placing the assembled Conquik panel on the prepared ground. Use a spirit level across the top of the Conquik panel to see how much the ground slopes and fill up the ground below the panel accordingly. This will eliminate concrete wastage. Be sure to compact the ground once it is level.

If needed, road base or crusher dust can be placed, levelled and compacted before laying the plastic.

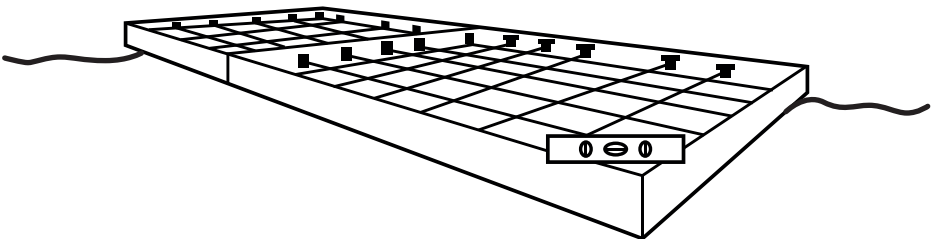

## **STEP 8 - Place the Conquik panel onto the plastic builders film**

Once the ground has been compacted, place the builders film into position ensuring that it extends beyond all sides of the Conquik panel. This will keep out moisture and make it easier to clean the site.

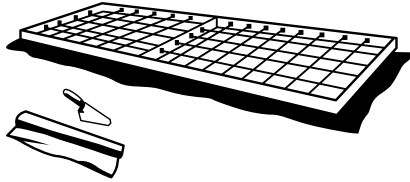

**FOR A SINGLE PANEL INSTALL, GO TO STEP 11.  
DO STEPS 9 & 10 IF YOU ARE JOINING TOGETHER 2+ PANELS.**

## **STEP 9 - Place panels together**

Place the two panels together, making sure to butt together the side-forms which had the top sections torn off in Step 2.

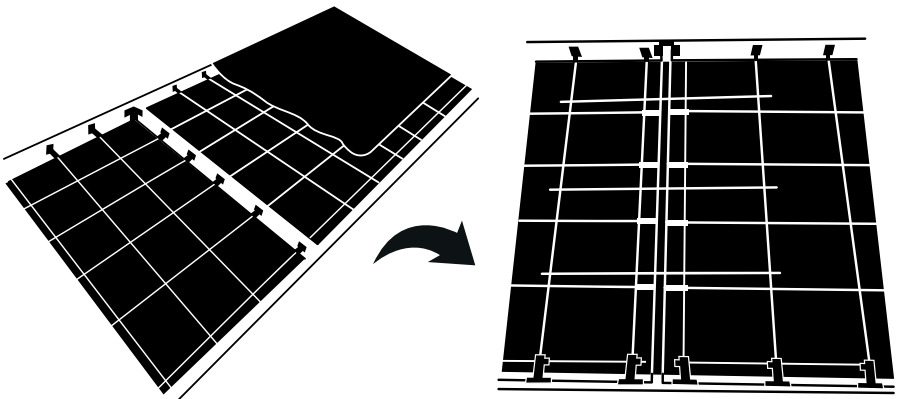

## STEP 10 - Secure panels together

Firstly, using either a drill or screwdriver secure the two panels together with 6-8 screws on both the top and bottom every 200mm-300mm.

Secondly, using a 10mm drill bit, drill through both panels every 300-350mm (starting 300-350mm from the panel corner) and place a steel dowel evenly in each hole. The dowels should extend 300mm on both sides, past two reinforcement bars in each panel.

## STEP 11 - Mix the concrete and pour the slab by shoveling the concrete into place

Mix the concrete in a wheelbarrow or on a mixing surface in accordance with the concrete manufacturer's instructions.



Start by placing a few shovel loads into each of the four corners. This will hold the panel in place. Continue filling the panel all the way to the top of the formwork, spreading it with a shovel to ensure that all edges and corners are full.

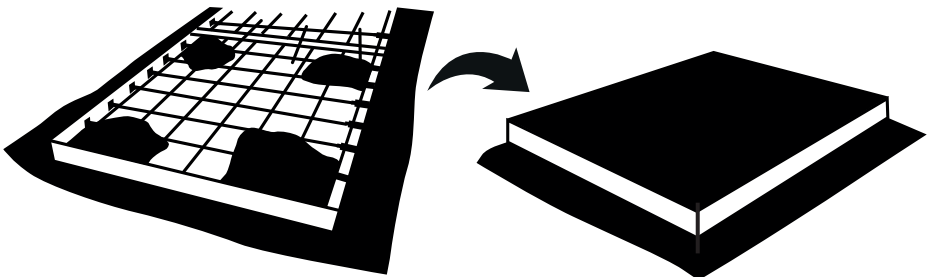

## STEP 12 - Tap the panel with a trowel handle or similar

Tap around the panel on the side-forms to get out any air pockets and ensure the concrete fills all the voids.

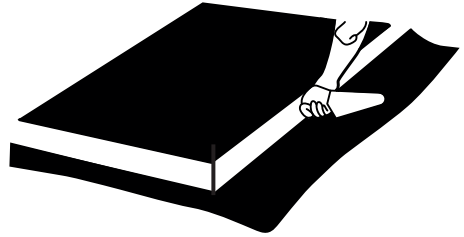

## STEP 13 - Level the concrete with a screed or timber straight edge

Level the concrete with a screed, working from one side to the other in a saw-like motion. It may be necessary to repeat this process several times to ensure that the surface is flat without voids. Fill any indents as you work the surface.

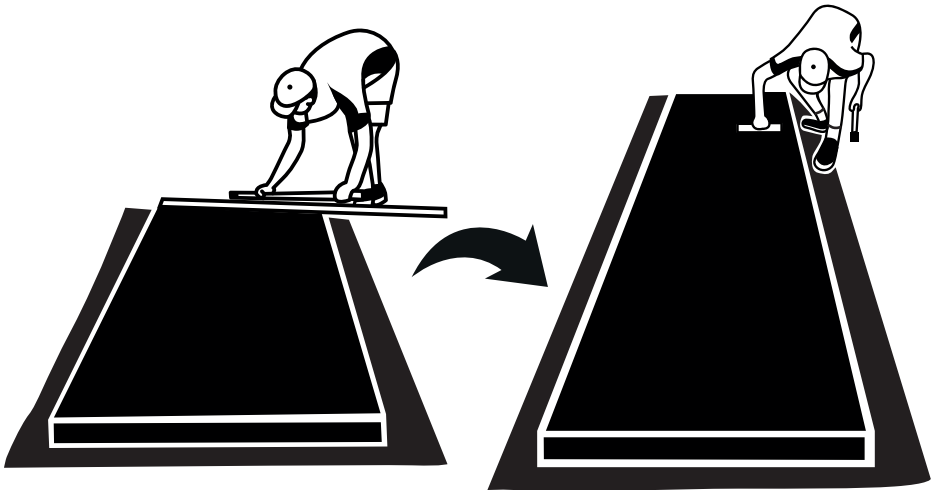

## STEP 14 - Finish the slab surface for a smooth (trowel) or rough (broom) finish

When the surface moisture has evaporated and the concrete has stiffened a bit, use a steel trowel to remove any ridges and produce a smooth final finish. If a rough surface is desired, use a broom or wooden float to produce a textured, non-slip surface.

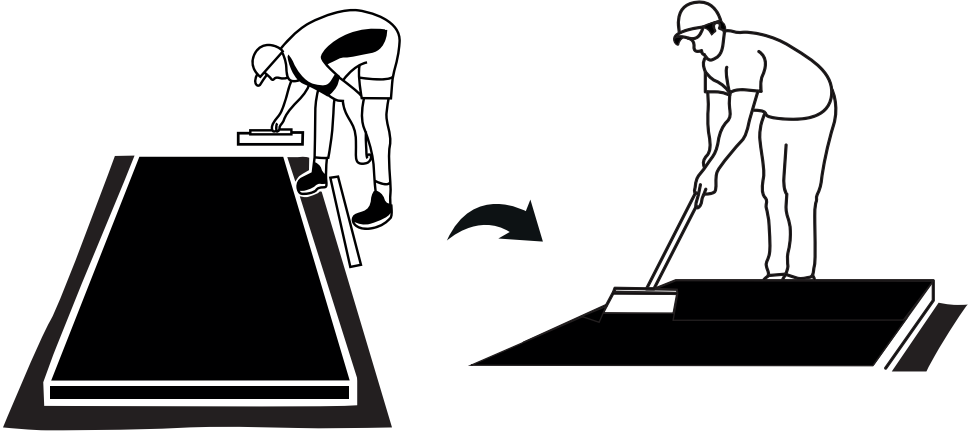

## STEP 15 - Clean the formwork & cut the builders film

- Use a wet sponge to wipe off the excess concrete on the side-form.
- When concrete has dried, use a Stanley knife or sharp edge to cut off the excess plastic sheet.
- Before installing fixtures to the slab, the concrete should cure according to the instructions given by the concrete manufacturer.

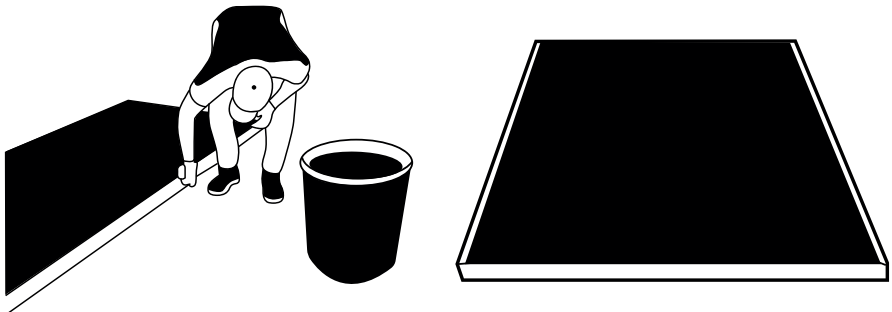

**YOUR SLAB IS NOW COMPLETE!**

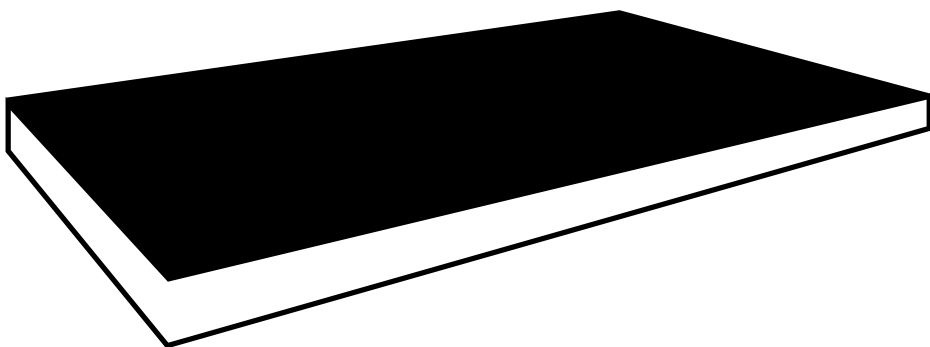
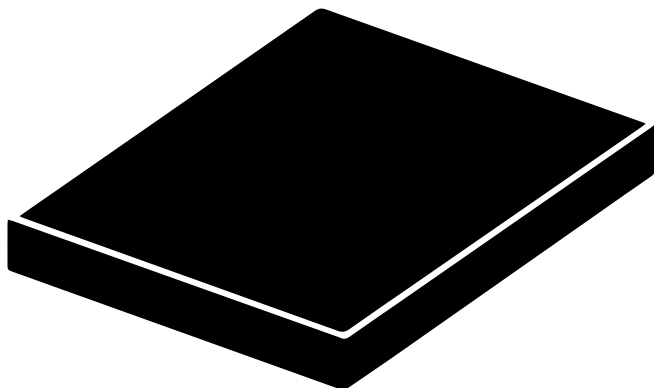

# WARRANTY

## 12 Month Limited Factory Warranty

**Conquik Slab-in-a-Box panels** ('Goods') are warranted to the original purchaser to be free from defects in material or workmanship for a period of 12 months from the date of purchase of the Goods. Defects arising from misuse, abuse or negligence of the Goods will void this warranty.

This warranty is limited to the supplied components only and does not cover any damages relating to concrete use, either direct (such as chipping) or indirect (such as weathering, including cracking or staining). Customers must install concrete as directed by the concrete manufacturer.

This warranty does not cover scratching, scuffing or discoloration of the Goods which may result from normal usage. Any defects caused by vandalism, intentional damage, negligence, improper use, or "acts of nature" will void the warranty. In addition, this warranty does not cover accidental damage or damage caused by an extra-ordinary event or circumstance beyond your or anyone else's control including damage caused by environmental factors, natural discoloration of material due to ultraviolet light, crushing, impact with hard surface or damage caused in the transit of the Goods, foreign material, or exposure of the product to excessive heat or cold or to solvents, or water entry into the Goods, abnormal Goods performance caused by any ancillary Goods interference or other external factors, improper or inadequate maintenance or calibration of the Goods, adverse external conditions including electrical power surges, spikes or dips, or fluctuations in voltage or current.

This warranty is nontransferable and is expressly limited to the repair or replacement of defective Goods. If the Goods are defective within the terms of this warranty, Conquik Pty Ltd will replace the defective parts at no cost to the purchaser. Shipping charges to and from the factory or distribution centre will not be covered and are the responsibility of the purchaser. Any associated labour charges for the removal, installation or replacement of the Conquik panel are not covered under this warranty.

The following statement applies if the supply of the Goods to the purchaser is a consumer sale as defined in the Australian Consumer Law. In this statement, 'Our' means 'Conquik Pty Ltd', 'You' means the 'Purchaser' and 'goods' means 'Goods':

*Our goods come with guarantees that cannot be excluded under the Australian Consumer Law. You are entitled to a replacement or refund for a major failure and for compensation*

*for any other reasonably foreseeable loss or damage. You are also entitled to have the goods repaired or replaced if the goods fail to be of acceptable quality and the failure does not amount to a major failure.*

What constitutes a major failure is set out in the Australian Consumer Law.

Notwithstanding the preceding clause and to the extent permissible by law, the liability of Conquik Pty Ltd is limited, in relation to the Goods and at the option of Conquik Pty Ltd to:

- replacing the Goods, or where the product no longer exists, the supply of equivalent goods;
- the repair of the Goods;
- the payment of the cost of replacing the Goods or of acquiring equivalent Goods; or
- the payment of the cost of having the Goods repaired.

To the extent permitted by law, all other warranties whether implied or otherwise, not set out in this Warranty are excluded and Conquik Pty Ltd is not liable in contract, tort (including, without limitation, negligence or breach of statutory duty) or otherwise to compensate the Purchaser for:

- loss of revenue;
- loss of profit or anticipated profit;
- loss of business;
- loss of business reputation;
- loss of opportunities;
- loss of anticipated savings;
- loss of goodwill; and
- any other loss suffered by a party as a result of a breach of this warranty that cannot reasonably be considered to arise directly and naturally from that breach.

The benefits given to the Purchaser in this Warranty are in addition to other rights and remedies under a law in relation to the Goods or services to which this warranty applies. This warranty is not applicable outside Australia.

To claim a warranty, please provide a purchase receipt and photographs of the damaged parts.

**To claim a warranty, please provide a purchase receipt and photographs of the damaged parts.**

To report product defects:

**Email: [sales@conquik.com.au](mailto:sales@conquik.com.au)**

**Post: PO Box 245, Alexandria, NSW 1435**

To find out where you can purchase other **Conquik** products visit us at:

[www.conquik.com.au](http://www.conquik.com.au)

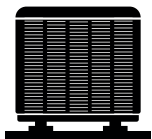

AIRCON UNIT PAD



BBQ PAD



WATER TANK PAD



GARDEN SHED PAD



ANY OTHER USE